

about

from page 1

Founded in 1974, New Arts Program is a 501(c)(3) nonprofit educational art resource library, museum, and exhibition space dedicated to providing a forum for the local public to interact with working artists from the literary, visual, and performing arts.

During its 46-year history, New Arts Program (called the “Art Series Program” for its initial eight years) has brought over 700 cutting-edge visual, performing, and literary artists and critics from around the world to the doorsteps of the Lehigh Valley, Berks County and Philadelphia.

Additional programs include internships, two monthly cable television programs, an art research and slide library, NAP archives, NAP Limited Print Editions, Live On Paper: Book Forms, and other publications.

residencies

Since 1974, artist residencies have been the cornerstone of the New Arts Program. Today’s most provocative and insightful visual, performing and literary artists and critics take part.

Each residency includes two days of personal one-to-one conversational meetings between the residency guest and members of the general public lasting an hour each. On the evening of day one, our guest conducts an open dialog with a public audience in a presentation/performance and/or exhibition context. This access to major talents—with NAP as a conduit—cultivates direct dialogue between artists and the public.

one-to-ones

One-to-one conversations are at the heart of the New Arts Program. During each residency there are a limited number of

hour-long time slots available for private conversations with the visiting artist. One-to-Ones are free—details on page 1.

public presentations

On the first evening of each residency, the public is invited to a social hour of conversation with the guest artist, which could include a gallery talk, slides, video or audio, and in certain instances, a performance. Performances and exhibitions are held in an intimate, relaxed public setting.

exhibitions

Eleven months out of the year, our intimate galleries feature solo exhibitions of first-rate working artists from America and abroad. Complimentary artist booklets, which include reproductions and conversation transcripts with residency artists, are available. Capping off each season is our ever-popular International Invitational Salon of Small Works.

reference library

Housed within the NAP Space, the **William Zimmer Reference Library** is an artist’s and researcher’s dream. The public is invited to use its resources at no charge. NAP members have exclusive borrowing privileges. Open gallery hours and by appointment.

Included in the collection are the personal libraries of artist Anne E. Neimann Hubbard and deceased critic/writer Bill Zimmer. Here you’ll find:

BOOKS—Every subject imaginable for the artist.

PERIODICALS—Current and lots of back issues.

EXHIBITION CATALOGS—Dating back 40 years, from here and abroad.

VIDEO ARCHIVE—Featuring NAP Video Festival winning works and a collection of residency presentations recorded over the past 30+

years. On-site screening.

SLIDE ARCHIVE—Over 50,000 slides of works by contemporary artists. On-site viewing.

CONSULTING and technical assistance on studio and arts management, alternative and co-op spaces, housing, and mailings.

residency booklets

Beginning in 1997, each NAP exhibition and artist residency has been documented with a booklet which includes reproductions of the works and commentary by and about the artists. Exclusive transcripts from “New Arts Alive” TV conversations are often included. Booklets are available free of charge at events. A small fee is charged for booklets by mail or from prior residencies.

group gallery tours

Call to arrange for a gallery tour for your group or class. Educators are encouraged to bring their classes—elementary through college. We can also schedule an educational visit to your group or classroom.

nap tv

New Arts Program produces two live one-hour TV programs every month—**New Arts Alive** and **NAP Connection**. Both series are streamed live and available on demand at bctv.org. Over 450 episodes have been produced since our first airing in 1988 and over 170 can now be viewed on demand. Just about every NAP residency artist is invited to do an episode to present and talk about their work. Find out more on page 9... and catch up.

the NAP store

Where else can you find a silk-screened Keith Haring poster for \$30? Gift certificates available. The NAP Store catalog appears toward the end of this *Preview*.

open Sundays

In addition to our Friday and Saturday hours, our galleries are open Sundays during our season from 11:00-3:00, except holidays. We’re actually here most other days, so if you’re in the neighborhood, give a ring or just knock.

website

Just a reminder if you ever find yourself without your *NAP Preview*, the latest one is waiting at newartsprogram.org. Plus there are past editions and lots more on the site to explore.

If you haven’t already seen a copy, don’t miss **NAP Synopsis** which can be located under the *Artists and Synopsis* tab. Stroll down memory lane or explore NAP’s amazing 49-year history. Residencies by over 450 artists, writers and performers are chronologically listed—1974 onward—along with other NAP highlights. Scroll to the very end of the page for a PDF download of your own copy of the complete *Synopsis* (use *Synopsis continued* link).

funding and support

New Arts Program would not be in operation without the generous support of its individual, organization and business sustaining sponsors; foundations; and a supporting membership base which includes persons like yourself. Funding is also provided in part by the Pennsylvania Council on the Arts, a state agency, and the National Endowment for the Arts, a federal agency.

Every so often the Program is blessed to have prominent performing artists donate time and talent for a benefit event. In April 2019 composer/musicians Philip Glass and Jon Gibson performed for an audience of 400 in Kutztown to benefit NAP. Glass, one of the greatest composers of our time, has been a longtime NAP advocate, engaging with us for twelve benefit concerts since 1985.

Your attendance at these events



New Arts Program

2022-2023 at a glance

newartsprogram.org
and on Facebook

fall

exhibition

8 printmakers

Printmakers from Romania

Stefan Balog
Alexandru Radulescu Jr.
Alexandru Radulescu Sr.
Anca Sas

Printmakers from the United States

Patricia Goodrich
Christina Pumo
Dan Welden
Douglas Zucco

Sep 9, 10 (Fri, Sat)
Sep 9 (Fri) - Dec 18 (Sun)
Sep 9 (Fri 6-9:00)
Dec 18 (Sun 11-3:00)

Residency <one-to-one hour-long conversational meetings by appt>
Exhibition <VISUAL POEMS: DICKINSON AND BLAGA>
Artist reception <gallery talk @7:30>
Closing day reception

winter

artist

Patricia Johanson

Jan 13, 14 (Fri, Sat)
Jan 13 (Fri) - Apr 16 (Sun)

Jan 13 (Fri 6-9:00)
Apr 16 (Sun 11-3:00)

Residency <one-to-one hour-long conversational meetings by appt>
Exhibition <SCULPTURAL LANDSCAPES: "MCMMASTER MONARCH" AND "MARY'S SEVEN SORROWS">
Artist reception <gallery talk @7:30>
Closing day reception with Johanson

spring - summer

33rd annual international invitational salon of small works

May 26 (Fri) - Jul 16 (Sun)
May 26 (Fri 6-9:00)

Exhibition
Artists reception

One-to-one conversations
Exhibitions
Presentations/Forums
Performances
Television programs
Reference library/Archives
Publications

Galleries / Library / Archives / Office
173 W. Main Street
P.O. Box 0082
Kutztown, PA 19530-0082
610 683-6440
napconn@gmail.com

HOURS: 11:00 - 3:00 FRI/SAT/SUN
[other times call ahead or just
knock, we're here most days]

Most events are free to attend.
There is never a charge for
One-to-One conversational
meetings with our guests.
For up-to-the-minute event details,
call 610-683-6440.

september 2022						
s	m	t	w	t	f	s
				1	2	3
4	5	6	7	8	9	10
11	12	13	14	15	16	17
18	19	20	21	22	23	24
25	26	27	28	29	30	

october						
s	m	t	w	t	f	s
						1
2	3	4	5	6	7	8
9	10	11	12	13	14	15
16	17	18	19	20	21	22
23	24	25	26	27	28	29
30	31					

november						
s	m	t	w	t	f	s
		1	2	3	4	5
6	7	8	9	10	11	12
13	14	15	16	17	18	19
20	21	22	23	24	25	26
27	28	29	30			

december						
s	m	t	w	t	f	s
				1	2	3
4	5	6	7	8	9	10
11	12	13	14	15	16	17
18	19	20	21	22	23	24
25	26	27	28	29	30	31

january 2023						
s	m	t	w	t	f	s
1	2	3	4	5	6	7
8	9	10	11	12	13	14
15	16	17	18	19	20	21
22	23	24	25	26	27	28
29	30	31				

february						
s	m	t	w	t	f	s
5	6	7	8	9	10	11
12	13	14	15	16	17	18
19	20	21	22	23	24	25
26	27	28				

march						
s	m	t	w	t	f	s
				1	2	3
4	5	6	7	8	9	10
11	12	13	14	15	16	17
18	19	20	21	22	23	24
25	26	27	28	29	30	31

april						
s	m	t	w	t	f	s
						1
2	3	4	5	6	7	8
9	10	11	12	13	14	15
16	17	18	19	20	21	22
23	24	25	26	27	28	29
30						

may						
s	m	t	w	t	f	s
	1	2	3	4	5	6
7	8	9	10	11	12	13
14	15	16	17	18	19	20
21	22	23	24	25	26	27
28	29	30	31			

june						
s	m	t	w	t	f	s
				1	2	3
4	5	6	7	8	9	10
11	12	13	14	15	16	17
18	19	20	21	22	23	24
25	26	27	28	29	30	

july						
s	m	t	w	t	f	s
						1
2	3	4	5	6	7	8
9	10	11	12	13	14	15
16	17	18	19	20	21	22
23	24	25	26	27	28	29
30	31					

2022-2023 season

visual poems: Dickinson and Blaga

8 printmakers: two poets



exhibition Fri Sep 9 through Sun Dec 18, 2022

New Arts Gallery, Kutztown
 gallery hours: 11 - 3:00 FRI/SAT/SUN

Printmakers from Romania, each
 responding to poetry of American
 poet Emily Dickinson:

Stefan Balog
Alexandru Radulescu Jr.
Alexandru Radulescu Sr.
Anca Sas

Printmakers from the United States,
 each responding to poetry of
 Romanian poet Lucian Blaga:

Patricia Goodrich
Christina Pumo
Dan Welden
Douglas Zucco

reception Fri Sep 9

6-9:00 pm artists reception
 7:30 pm gallery talk

one-to-ones Fri and Sat Sep 9, 10

10:00 am-3:00 pm
 Individual hour-long conversational
 meetings with Patricia Goodrich and
 Douglas Zucco by appointment:
 610-683-6440

closing day reception Sun Dec 18

11:00 am-3:00 pm

Alexandru Radulescu Sr., *I lost a
 world the other day*, 2019, woodcut
 on paper, 20" x 16"

Eight printmakers—four from
 Romania and four from the
 United States—were invited to
 respond to the poetry of two
 icons, American poet Emily
 Dickinson and Romanian poet
 Lucian Blaga, respectively. They
 employed a variety of printmak-
 ing techniques including
 lithograph, screen print, solar,
 and collagraph. Each artist is
 represented by six prints with
 excerpted text from the poems
 accompany the prints.

Lucian Blaga was born on
 May 9, 1895. As part of the
 Romanian celebration of his
 125th birthday anniversary, the
Visual Poems exhibition opens
 August 2020 at the National
 Museum of Unification-Alba
 Iulia, Romania.

Emily Dickinson was born
 December 10, 1830—190 years
 ago. May 15, 2021, is the 135th
 anniversary of her death in
 1886.

Offering a cross-pollination of
 cultures, the Romanian artists
 respond to Dickinson's poetry
 and the Americans to Blaga.
 Together, they create a visual
 conversation, a dialogue for an
 engaging exhibition that crosses
 borders—between countries,
 between art forms, and between
 artists.

Exhibition booklet available

*Exhibition funding in part through
 the generosity of local businesses,
 Berks Arts Council, and Pennsylvania
 Council on the Arts*

PHOTO: GERRIT GOOSSEN



Dating as early as 1969, Patricia Johanson's site-specific designs which combine art, ecology, landscaping, and functional infrastructure have established her as a leading pioneer in the field of ecological art (or eco-art). During the 1960s and 1970s she worked for Joseph Cornell and Georgia O'Keeffe and designed a series of 150 gardens for *House & Garden* magazine.

Her major projects have transformed municipal flood basins, sewers, water-treatment systems, flood control structures, and restored habitats into accessible landscapes that are framed by sculpture and used and enjoyed by the public.

Johanson's work has been featured in over 150 exhibitions worldwide, and her writings have been translated into eleven languages. She is author of *Creative Solutions to Environmental Problems* (1992), *Preserving Biocultural Diversity in Public Parks* (1996), and *The City as an Ecological Art Form* (1998).

Johanson's project drawings and models are preserved in the permanent collections of the Metropolitan Museum of Art and Museum of Modern Art.

Designed in 2008, a mammoth

artist (American, b. New York City, 1940)

Patricia Johanson

one-to-ones
Fri and Sat Jan 13, 14, 2023

10:00 am–3:00 pm
 Individual hour-long conversational
 meetings with Patricia Johanson
 by appt: 610-683-6440

**exhibition <Sculptural Landscapes:
 "McMaster Monarch" and
 "Mary's Seven Sorrows">**
**Fri Jan 13 through
 Sun Apr 16**

New Arts Gallery, Kutztown
 gallery hours: FRI/SAT/SUN 11:00–3:00

opening Fri Jan 13
 6–9:00 pm reception with Johanson
 7:30 pm gallery talk

closing day reception
Sun Apr 16
 11:00–3:00 reception with Johanson

land reclamation garden in
 Scranton, Pa., in conjunction
 with Marywood University,
 informed the "Mary's Seven
 Sorrows" drawings included in
 this NAP installation.

"My plan for McMaster
 University's new research
 campus in Hamilton, Ontario
 (2019-2022) is based in nature,
 and my goal has been to design
 the entire project as 'Land Art'
 encompassing 45 acres—a
 massive swath of territory
 within an urban setting.
 'McMarsh,' is an extensive
 mosaic of wetlands that would
 replace a thousand-car parking

below: *Mary's Garden: Iris versicolor*, *Mary's First Sorrow*:
Simeon's Prophecy, 2009, acrylic and ink on vellum, 45.5" x 40",
 Collection Nathaniel Goossen
 next page: *McMaster University: McMarsh and West Campus Site Plan*,
 2022, ink, pencil and colored pencil on vellum, 29" x 26"



lot with ponds, marsh, and wet
 woodlands, all linked together
 and deployed to purify storm
 water and provide food and
 habitat to birds, waterfowl,
 amphibians and turtles. Plants
 have been selected to remove
 specific pollutants from the

water, as well as frame educa-
 tional and research interests.
 "The overall image for
 McMaster's West Campus is the
 Monarch butterfly, that begins
 its epic 3,000-mile journey from
 this site in Canada every year to
 overwinter in Mexico."—P.J.

Mc Master University
 "Mc Marsh" + West Campus
 Site Plan

© Patricia Johnson

4/22

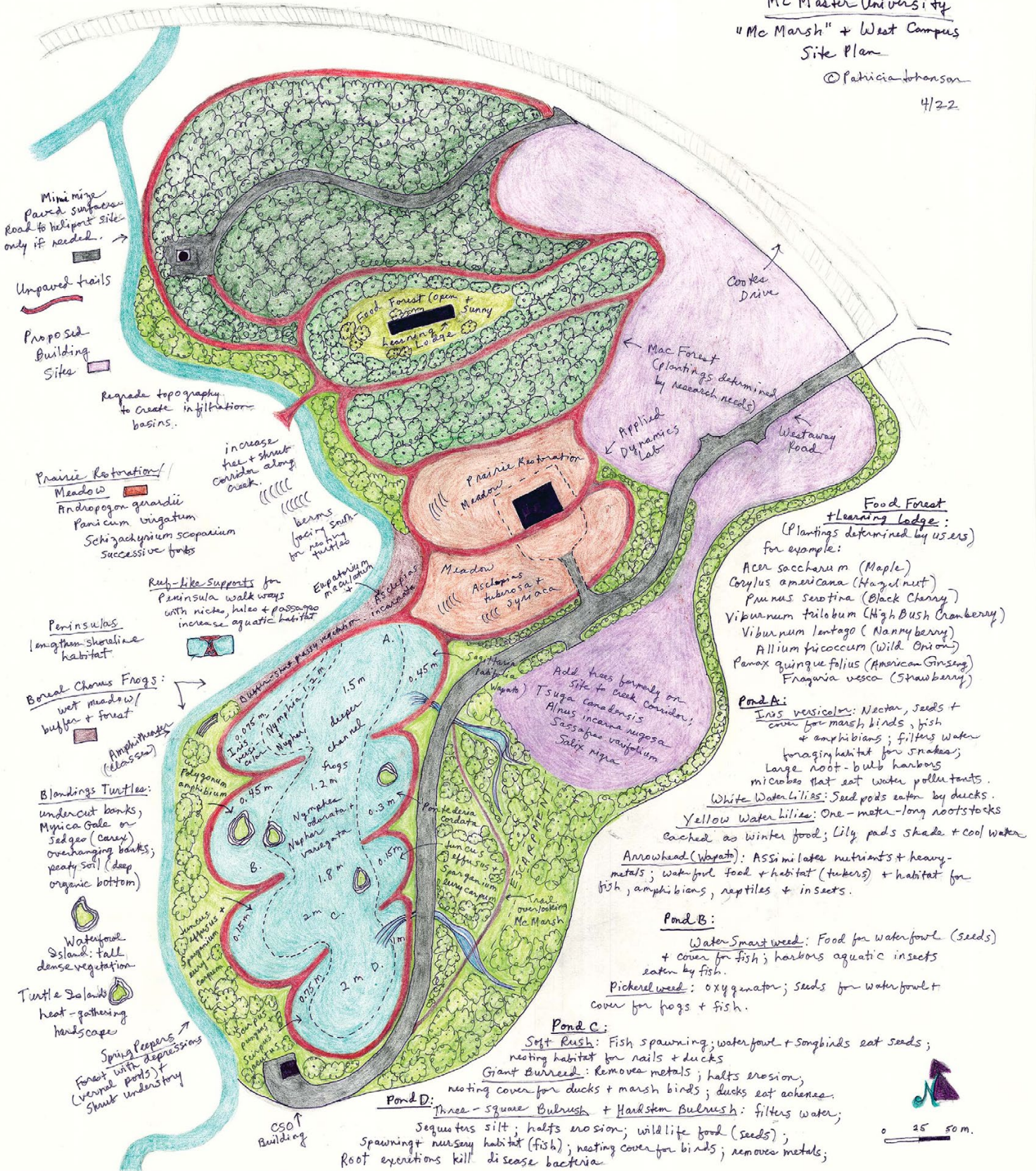

Mimimize Paved surfaces. Road to heliport site only if needed.

Unpaved trails

Proposed Building Sites

Regrade topography to create infiltration basins.

Prairie Restoration Meadow

- Andropogon gerardii*
- Panicum virgatum*
- Schizachyrium scoparium*
- Successive forbs

increase tree + shrub corridor along creek.

berms facing south for nesting turtles

Ref-like Supports for Peninsula walk ways with nicks, holes + passages increase aquatic habitat

Peninsulas lengthen shoreline habitat.

Boreal Chorus Frogs: wet meadow/buffer + forest

Amphibian (class)

Blundings Turtle: undercut banks, Myrica Gale or Sedges (Carex) overhanging banks; peaty soil (deep organic bottom)

Waterfowl Island: tall dense vegetation

Turtle Islands heat-gathering hardscape

Spring Peepers Forest with depressions (vernal pools) + shrub understory

CSO Building

Food Forest (Open + Sunny) Learning Lodge

Prairie Restoration Meadow

Meadow *Asclepias tuberosa + Syriaca*

Eupatorium maculatum + Asclepias incarnata

Cooke Drive

Mac Forest (plantings determined by research needs)

Applied Dynamics Lab

Westaway Road

Food Forest + Learning Lodge

(Plantings determined by users) for example:

- Acer saccharum* (Maple)
- Corylus americana* (Hazel nut)
- Prunus serotina* (Black Cherry)
- Viburnum trilobum* (High Bush Cranberry)
- Viburnum lentago* (Nanny berry)
- Allium tricoccum* (Wild Onion)
- Panax quinquefolius* (American Ginseng)
- Fragaria vesca* (Strawberry)

Pond A:

Iris versicolor: Nectar, seeds + cover for marsh birds, fish + amphibians; filters water foraging habitat for snakes; large root-bulb harbors microbes that eat water pollutants.

White Water Lilies: Seed pods eaten by ducks.

Yellow Water Lilies: One-meter-long rootstocks cached as winter food; Lily pads shade + cool water

Arrowhead (Worath): Assimilates nutrients + heavy-metals; waterfowl food + habitat (turtles) + habitat for fish, amphibians, reptiles + insects.

Pond B:

Water Smart weed: Food for waterfowl (seeds) + cover for fish; harbors aquatic insects eaten by fish.

Pickered weed: oxygenator; seeds for waterfowl + cover for frogs + fish.

Pond C:

Soft Rush: Fish spawning; waterfowl + Songbirds eat seeds; nesting habitat for rails + ducks

Giant Burreed: Remove metals; halts erosion, nesting cover for ducks + marsh birds; ducks eat achenes.

Pond D: Three-Square Bulrush + Hardstem Bulrush: filters water; *Sequoia silt*; halts erosion; wildlife food (seeds); Spawning + nursery habitat (fish); nesting cover for birds; remove metals; root excretions kill disease bacteria.

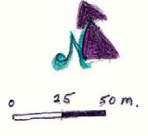



NAP 33rd annual international invitational

salon of small works



above: Radiating like gemstones, a selection of works on the walls of NAP's main gallery during the 2022 edition of the annual salon.

left: *Leave Peacefully*, a watercolor painting by artist Rich Dethlefsen exhibited in the 2022 salon. right: Another marvelous watercolor painting from the same show, by Anne Landis.

exhibition
Fri May 26 through
Sun Jul 16, 2023

New Arts Gallery, Kutztown
 gallery hours: 11 - 3:00 FRI/SAT/SUN

opening reception
Fri May 26

6:00-9:00 pm artists reception

Our annual salon is a regional gallery goers' favorite. Opening night is a blast—it's always packed and many of the artists are there. There is tremendous diversity of styles and media, including video. A total of 115 artists were represented at the 2021 salon—71 from 5 states and 44 from 28 foreign

countries. The number of incredible international entries makes this show that much more exceptional.

Each artist is represented by one recent work measuring up to 200 sq. inches. Most works are for sale, reasonably priced, and many already framed. It's nearly impossible to walk away without claiming something. Some visitors have made it an annual tradition to buy at least one piece.

Artists interested in exhibiting, see **Call for Entries**, next page.

Exhibition booklet available

7

Exhibition funding in part through the generosity of local businesses



grab a bite or brew,
get 10% off

On your next NAP visit, why not grab a bite or brew at one of our supporting eateries. Show your NAP membership card; some offer 10% off to NAP members. *Supporting businesses are listed at the end of this Preview.*

call for entries
for the 2023 salon
[that's right, this one]

All artists—local, national, and international—are invited to exhibit. Unlike in other years, no need to apply ahead. See next page for entry guidelines and delivery instructions.



call for entries

visual artists

new arts program annual international invitational salon of small works

WHAT: Begun in 1990, this yearly event has been the climax of the NAP season. Artists are invited to submit one recent original work in any medium, measuring up to 200 sq. inches. Sale of work is encouraged (15% commission).

LOCATION:

New Arts Gallery
173 W. Main Street
Kutztown, Pa. 19530

Works above, exhibited at the 2022 salon, are by (l to r) Ron Schira, Densaborou Oku, and Durand Petizil.

33RD EDITION (2023)

EXHIBIT OPENS: Friday, May 26, 2023. Artists reception 6:00-9:00

EXHIBIT CLOSSES: Sunday, July 16. Closing reception: 11:00-3:00

DEADLINE TO EXHIBIT:

Follow dropoff/pickup instructions at right. No pre-application.

TO QUALIFY: The annual NAP Salon is open to any artist—local, national and international. NAP membership is appreciated but not required.

TO APPLY: There is no application form. Unlike some other years, pre-application and slides are not required to exhibit.

ENTRY FEE: \$5 US due with entry delivery.

RESTRICTIONS:

- One work per artist
- Work completed within the past two years
- Size limit: 200 square inches, including frame
- Works are intended to hang on a wall (except video/film). Work should have hanging hardware installed (wire, etc)
- Label on back:
 - artist's name
 - title of work
 - date
 - medium
 - dimensions: H×W (×D)
 - price (15% commission will be deducted from price)
 - contact phone # and/or email
- Video and film entries must be on DVD, 14 minutes or less, including credits (screening accommodations provided)

DROPOFF/PICKUP

IN-PERSON DROPOFF:

May 4-7, 11:00-3:00.
\$5 US entry fee due at this time.

SHIPPING DELIVERY:

Ship to arrive May 1-7. Enclose \$5 US entry fee (check, money order). Artist pre-pays delivery postage/freight costs, both ways.

ENTRY DELIVERY LOCATION:

New Arts Program
P.O. Box 82
173 W. Main St.
Kutztown, PA 19530-0082

ENTRY PICKUP DATES:

In person pickup
— July 16, 3:00-5:00
— July 17 and 18, 11:00-3:00

Shipped works require prepaid postage and will be returned July 24.

MORE INFO

610-683-6440
napconn@gmail.com
www.newartsprogram.org
Facebook: New Arts Program

nap on demand 101

Television program funding in part by the Pennsylvania Council on the Arts, Berks Community Television, local businesses, and individuals

New Arts Program produces two live one-hour TV programs every month that are televised to over 110,000 cable households in the Berks County area and streamed live over www.bctv.org. Over 450 NAP programs have been produced at Berks Community TV in Reading since our first airing in 1988.

new arts alive

Our flagship series, **New Arts Alive**, features a single guest—a painter, sculptor, writer, poet, critic, architect, choreographer, dancer, musician, composer, performance artist, curator, or gallery dealer—in conversation about their passion of how and why they do what they do. Just about every NAP residency artist is invited to do an episode to present and talk about their work. NAP director James Carroll or critic Ron Shira add commentary.

nap connection

In 1992, a second series was added, **NAP Connection**—Critic Ron Shira covers the regional arts scene. The program often includes live interviews with regional artists.

streaming live

James Carroll hosts “Alive” and **Ron Schira** is NAP Connection’s reporter and host. No matter who James or Ron has on board as a guest—or what their topic—the conversation is guaranteed to be thought provoking. Viewers can join the dialog by phone during the live BCTV telecasts. Dial in live at 610-378-0426. Shows are streamed live on the Web at www.bctv.org.

Available anywhere

Streamed live on www.bctv.org:
FIRST Wednesdays 6:00 pm
FOURTH Wednesdays 7:00 pm

In Berks County, tune in BCTV twice monthly for live broadcasts:

FIRST Wednesdays 6:00 pm
[Repeats that Fri 9:00 pm;
Sat 5:00 pm; Sun 8:00 am]

FOURTH Wednesdays 7:00 pm
[Repeats that Fri 10:00 pm;
Sat 6:00 pm; Sun 9:00 am]

BCTV availability:

- Comcast Reading/Hamburg Channel 13
- Comcast Oley Channel 4
- Service Electric Cablevision Channel 19 [Birdsboro, Fleetwood, Kutztown]

Berks Community Television is at:
1900 N. 13th St., Reading, PA 19604
610-374-3065

on demand anytime

Bctv.org has made accessing recent and past episodes of “New Arts Alive” and “NAP Connection” easy peasy. Follow these steps for either series. We show laptop screen shots, but adapting them to your phone should be no problem.

over 170 episodes

To watch any of 100+ previous episodes of “Alive” dating back to 2010, or the nearly 70 episodes of “Connection” dating back to 2008, follow the last couple steps at right.

follow this path:

bctv.org

Go to www.bctv.org



On the homepage, open MENU.



From the MENU topics, select “Arts & Culture.”



Programs

Hovering over the “Arts & Culture” box, select “Programs” icon



to reach the Programs page. Scroll down through the programs to “New Arts Alive” [or “NAP Connection”]

–On your computer/laptop, click “Read More.”

–On your phone/iPad, click the image.



The most recent New Arts Alive episode appears, ready to watch and share. Enjoy.

To watch any of 100+ previous episodes dating back to 2010:



Click the Playlist icon located in the upper right-hand corner of the current video frame.

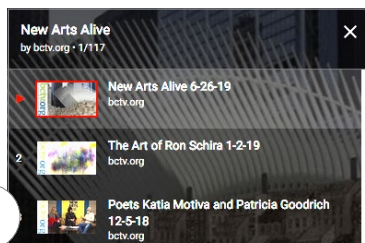

Select from a list of 100+ New Arts Alive episodes.

Follow all the same steps for NAP Connection and you’ll reach a playlist of nearly 70 episodes dating back to 2008.



Circa 2012, from left: **Joe Beddall**, **Philip Glass**, **Joseph Kubera**, **Paul Harryn**, **Susan Manspeizer**, and **Ted Ormai**

10 years back

Turning the dial back to the '12-'13 NAP season, joining us for residencies were:

Joe Beddall
painter, sculptor

Paul Harryn
artist, musician, author

Susan Manspeizer
sculptor

Ted Ormai
painter, sculptor

This season had its share of special presentations and concerts. Filling out the season were:

Philip Glass
composer, musician

Roy Kinzer
painter

Joseph Kubera
pianist

Helene Zucco
artist, printmaker, educator

This article is a time capsule—intended to spark memories for some—recalling NAP residency artists as they were then. We've included biographic snippets and portraits from the '12-'13 *NAP Preview*—current when published, gaining age now.

The NAP experience continued into the 2012-13 season with a total of three concerts, including the return of Philip Glass for another benefit concert, some fantastic visual artists coming in for residencies, and a loaded exhibition schedule.

To visit every year of NAP's history since 1974, look for the

NAP Synopsis booklet on our website, newartsprogram.org, or ask for a copy next time you stop by the gallery.

This fall [2012] we converted the main gallery foyer into a new exhibition space we dubbed "**The Project Wall**." The Wall gave the public an opportunity to see artists' ideas and work in progress. On the 8' high by 14'-wide span, an invited artist installed a body of work that evolved over a 12-week period, often with public collaboration. Each passing week brought on change and exploration.

Kicking off the Project Wall series in October was **Helene Zucco** and her installation "Artists and Alzheimers." With husband Doug Zucco, Helene, founded White Crow Paper Mill in Fleetwood. Helene studied printmaking and painting at the Pennsylvania Academy of Fine Arts in Philadelphia. Her innovative works in hand-cast paper are exhibited in museums and sold in galleries throughout the U.S. and Europe.

[UPDATE '22: After a great run, we retired The Project Wall following the 2019 fall installation that featured visual artist/teacher George Shortess.]

Still active at the time was NAP's **Artists & Writers Forum**—a gathering of musicians, poets, writers, and visual and performing artists held on third Tuesdays eight months out of the year at the NAP Space. Artists brought

their work in for discussion and conversed about ideas, spawned collaborations, and pooled resources. **Lincoln Fajardo** kept order. [This was the Forum's 10th and final season.]

Paul Harryn, artist, musician and author, was the first of two visual artists with residencies this fall. For thirty years, Paul Harryn's career has been a commingling of painting, musical composition, performance, and installation. Much of the work over the past ten years has been created outdoors in the woods near the Delaware River, between the Pocono Mountains and Upper Bucks County.

In conjunction with his NAP residency and exhibition Harryn lead **The Absentee Ensemble** in a concert at St John's UCC benefitting NAP. Collaborating with Harryn were Richard Dee and Thomas Kort on keyboards. [UPDATE '22: Since 2012's NAP residency, Harryn's museum and gallery exhibition schedule hasn't let up, not to mention, large-scale commissions almost non-stop into 2022. Allentown Art Museum exhibited 130 of Harryn's large-scale paintings, videos, and installations through winter/spring 2013-2014. Between 2015 and 2017 he completed several large-scale paintings for public spaces in downtown Allentown (City Center Lehigh Valley, PPL, Renaissance Hotel, and Allentown Public Library). In 2015, San Diego Museum of Contemporary Art added Harryn's work to their permanent collection. In 2019 he published a 224-page painting anthology entitled **The Ritual of Painting: Paul Harryn**. The following year

he launched a *Vimeo*: *Paul Harryn* channel of monthly video journals which includes documentation of all work including painting, drawings, prose, photographs and original musical compositions—over 70 video productions available for public display.]

Painter/sculptor **Ted Ormai** followed Harryn with a residency and exhibition opening in November. A lifelong artist from a family of artists, Ormai was born in New York City and now lives and works in rural Pennsylvania. For four decades he has been a practicing artist in various media—drawing, light-works, installations, outdoor sculpture, magnetic artwork, and interdisciplinary collaborations with dancers and musicians. He is widely represented in the collections of museums, universities and individuals. Ormai was a 1970 Liberal Arts graduate of Pennsylvania State University; traveled to Africa, the Middle East and Europe; worked as a lighting technician and cameraman for PBS; and was an Associate Artist with Robert Morris at the Atlantic Arts Center in Florida. [UPDATE '22: Ormai continues to use magnets and mirrors in his work and has been making large-scale magnetized rust drawings on canvas. Exhibitions of note have included *Vision-Sound Revisited* at Muhlenberg College, Allentown [2017], *Chain Reaction* at The Painting Center, NYC [2018], and the *Intercontinental Biennial of Small Graphics*, Aiud, Romania [2018]. He has been on the

—more, page 11

10 years back

from page 10

board of directors and vice president of the New Arts Program from 1990 to present.]

Also this fall we welcomed **Philip Glass** to Kutztown for a live concert Saturday October 13 to benefit the New Arts Program. St John's UCC sanctuary provided ideal acoustics for the audience of nearly 400.

Through his operas, his symphonies, his compositions for his own ensemble, and his wide-ranging collaborations with artists ranging from Twyla Tharp to Allen Ginsberg, Philip Glass has had an extraordinary and unprecedented impact upon the musical and intellectual life of our times. Born in Baltimore, Glass is a graduate of the University of Chicago and the Juilliard School. By 1974, Glass had created a large collection of new music for the Philip Glass Ensemble. This period culminated in the landmark opera, *Einstein on the Beach*. Since *Einstein*, Glass' repertoire has expanded to include music for opera, dance, theater, chamber ensemble, orchestra, and film. [UPDATE '22: In all, Glass has had 12 concert engagements with NAP, the last and final in fall 2019—that's one every three years! *Thank you, Philip!*]

The 2012-2013 winter schedule continued the run of visual art consultation residencies and back-to-back exhibitions. Sculptor **Susan Manspeizer** was first with her exhibition "The Shell Series."

Susan Manspeizer has been an exhibiting artist for more than 30 years. She is widely known for her ability to bend wood for use in constructing her linear, personal sculptures. Manspeizer has had 20 solo exhibitions throughout her career. She is represented in New York City by

Walter Wickiser Gallery, and in Sarasota, Fl., at State of the Arts Gallery. A recipient of numerous awards, she is published in *Who's Who of American Women*, 19th ed., and *Who's Who in American Art*, 21st ed. Manspeizer teaches at Art Center of Northern New Jersey.

[UPDATE '22: Since 2013, Manspeizer has had a string of solo shows running into 2022 and has continued her association with the Walter Wickiser Gallery. See what she's been up to at susanmanspeizer.com]

Manspeizer's exhibition was followed by dual solo shows of painter/sculptor **Joe Beddall's** work, one at Northampton Community College [Bethlehem, Pa.] the other at the NAP Main Gallery in Kutztown.

Beddall has spent the past 30 years of his creative life as a visual artist in the Washington, DC, and State College, Pa., areas. In 2011, he was awarded a five-week residency in Obama, Japan, where he created public sculpture for the city. More recently he spent a four-week residency in Thimphu, Bhutan, conducting workshops and installing work at the VAST arts organization. His work is in public and private collections throughout the U.S., Europe and Asia.

Beddall was born in Reading, Pa. Upon graduation from Kutztown State University in 1978, with a degree in Art Education, he moved to the Washington, DC, area where he undertook further studies in printmaking and ceramics at Northern Virginia Community College and Hinckley Pottery Studios. After 14 years in DC, he relocated to State College completing additional course work at Penn State.

[UPDATE '22: Since his NAP residency, Beddall has continued his visual investigations primarily in the same two modes that have come to define his work that he labels "Screenworks"—paintings on metal window

screen—and "Waterworks"—studies of the effects of evaporation and weather on painted aluminum surfaces that he submerges in water. Through these recent works Beddall addresses social issues like the covid epidemic, racism, health-care and the economy. A one-man show at the Bellefonte [Pa.] Art Museum in late 2020 was a recent high point. See recent work posted on his Instagram account: [joe.beddall](https://www.instagram.com/joe.beddall). Also visit joebeddall.com.]

Pianist **Joseph Kubera** came by this spring for a conversational residency that included a public recital in April at St John's UCC. Kubera has been a leading interpreter of contemporary music for the past three decades. As a soloist he is in demand at music festivals throughout Europe and has worked closely with such legendary composers as John Cage, Morton Feldman, La Monte Young, and Robert Ashley. Kubera is a core member of S.E.M. Ensemble, the Downtown Ensemble, and Ostravska Banda and has performed with a wide range of ensembles, from Steve Reich to the Brooklyn Philharmonic. He has toured extensively with the Cunningham Dance Company (at John Cage's invitation) and has recorded Cage's *Music of Changes* and *Concert for Piano and Orchestra*. Kubera's playing is heard on the *Wergo*, Albany, New Albion, New World, Lovely Music, O.O. Discs, Mutable Music, Cold Blue, and Opus One labels. He earned degrees in performance from SUNY Buffalo, studying piano with Leo Smit, and from the Peabody Conservatory where he studied with Walter Hautzig. [UPDATE '22: Since 2013, Kubera has continued to champion John Cage's work on record and in live performance. On a 2016 CD release he performs with frequent NAP performing guest Jon Gibson, recently deceased.]

Every so often NAP has an opportunity to offer an artists' or writers' clinic to the public. In April we hosted a free **acrylic clinic** with **Golden Artist Colors** representative **Roy Kinzer**. We owe St. John's UCC thanks for use of their Fellowship Hall for the event. Kinzer demonstrated his personal painting process to illustrate a variety of Golden products. Attendees learned how glass and mediums can extend paint and create unique textural surfaces. Priming technique and health and safety concerns were also discussed. Attendees received a free packet of literature and Golden samples.

Roy Kinzer has an MFA degree from Vermont College and a Certificate of Art from Pennsylvania Academy of Fine Art. He has exhibited extensively and received the prestigious Pollock-Krasner award in 2004. His current paintings are aerial landscapes derived from altered maps and satellite images. His numerous commissions include the Hyatt Regency New Orleans, opened in October 2011. In 2013, Penn State Berks in Reading acquired four of Kinzer's paintings for their science building. [UPDATE '22: Kinzer continues to make and teach art in New York City. His lecture/demo gig with Golden is ongoing. In 2014 Golden introduced their QoR line of modern watercolors and continues to be a leading industry innovator.]

Summer 2013 arrives and we've reached number 24 of the **Annual NAP Invitational Salon of Small Works**. Again held May into July, it remains one of the areas most anticipated gallery outings. Nearly 200 works. [UPDATE '22: Ten years later, the tradition continues. In the intervening years, the Salon has blossomed into an international show, with a sizable representation from Haiti, Romania and China. See page 7 of this *Preview* for information on this year's edition.]

once a year pledge thirty to NAP



New Arts Program cannot survive on funds from only the PA Council on the Arts, foundations and businesses. NAP needs your support. Individual support is crucial to keeping small and unique organizations like the NAP afloat. By becoming a New Arts Program annual supporting member, you help make the following opportunities available **free to the public**:

- Conversational one-to-one consultations with residency artists
- Exhibitions and exhibition booklets
- In-house use of professional art reference library
- NAP television programming • This events calendar

Additionally, supporting members receive:

- Free admission to performances (excludes benefit concerts)
- Discount on prints and artwork (some exceptions)
- Art reference library exclusive borrowing privileges
- Satisfaction of keeping the New Arts Program vital

NAP is a unique nonprofit art resource organization dedicated to providing a forum for the public to interact one-to-one with today's most provocative and insightful artists from the literary, visual and performing arts.



supporting
member
application



- Check one: **\$30.-INDIVIDUAL** one year [365 days]
 \$50.-FAMILY one year [adult couple & their children]
 This is a renewal [No lapse. Extends effective expiration date by 365 days.]

I am pleased to include an additional tax-deductible gift to support NAP's goals:

- \$200 \$150 \$100 \$ _____
 I wish this gift to be used exclusively for the NAP Endowment Fund.
 I wish to remain anonymous.

today's date (month / day / year) ____ / ____ / _____

name(s) _____

occupation/discipline _____

address _____

city/state/zip _____

email _____

phone (_____) _____

Mail with check to: **New Arts Program, PO Box 0082, Kutztown PA 19530 - 0082**

fine art finds

signed limited edition prints from NAP collection for sale

The last our of John Cage prints is sold, but New Arts holds many other museum-quality art works that are intended for sale. Like the Cage prints, most are from the **NAP Limited Print Editions** collection which consists of over 60 editions by cutting-edge visual and performing artists created between 1979 and 2007, including an edition by famed choreographer Bill T. Jones.

These works by composers, architects, choreographers, sculptors, painters and critics were created during residencies at New Arts Program. Many were individually hand painted or otherwise altered by the artists and are remarkable for their ingenuity and idiosyncratic use of the medium. The small print runs of etchings, lithos, monotypes, and silk-screen prints number somewhere from two to 25 per signed edition.

We often have available for sale other fine works that are periodically donated to the Program. Private collector, corporate, gallery, and museum inquiries are welcome. Call or email us and we'll fax or email you a complete list of works. Discount pricing is available to NAP members. Sales benefit NAP. Please call for an appointment (610-683-6440). You won't leave empty-handed!

Signed prints or other works by the following artists are for sale:

Roberta Allen, sculptor
Robert Ashley, musician/composer
Connie Beckley, sculptor
Johanna Boyce, choreographer/dancer
Glenn Branca, musician/composer
John Cage, composer [sold out]
Ping Chong, multimedia
Efrain deJesus, painter
Tullio Desantis, artist
Peter Eisenman, architect

Molissa Fenley, choreographer/dancer
Ellen Fisher, performance artist
Jon Gibson, musician/composer
Jeremy Gilbert-Rolfe, painter/critic
Malcolm Goldstein, musician/composer
Peter Gordon, musician/composer
Edgar Grana, musician/composer
Denise Green, painter
Marcia Hafif, painter
Keith Haring, painter
Bill T. Jones, choreographer/dancer
Ralph Lemon, choreographer/dancer
Frank Lima, poet
Alvin Lucier, musician/composer
Joseph Masheck, art historian/critic
Steven Paul Miller, poet
Michael Morin, printmaker
David Moss, musician/composer
Steve Poleskie, artist
Lucio Pozzi, sculptor
David Shapiro, poet/critic
Irene Stein, artist
Barbara Strawser, painter
Valentine Tatransky, art historian/critic
Valery Taylor, sculptor
Julius Tobias, sculptor
Bernard Tschumi, architect
Maryann Unger, sculptor
Peter Van Riper, musician/composer
Ursula Von Rydingsvard, sculptor
Lawrence Weiner, painter
Arnie Zane, photographer/dancer/
choreographer

collectible posters

Along with our limited-edition print collection, the Program currently offers some attractively priced collectible posters, including two **Keith Haring** editions (*shown on page 16*) and one by **Robert Stanley**. We're especially fond of Stanley's 1985 edition, available signed and unsigned. This is a big one by an important twentieth-century American artist, striking in any office setting. View and purchase posters in person at the NAP Gallery. Or mail order from the **NAP Store**, *See next page*.



John Yau/Max Gimblett, *Leaves from a Chinese Album*, 2003, handmade paper, copper, 21" diameter x 1" deep, edition of 12 albums. Each one includes 15 leaves. Pictured, six of 15 leaves with their copper canister in a gallery setting.

books out of bounds

Live on Paper: Book Forms—

Since 1995, NAP and White Crow Paper Mill have collaborated to invite internationally recognized artists in the literary, visual and performing arts to create limited editions which stretch the boundaries of book form. These unique exhibition pieces, limited to editions of 10 to 12, can be purchased at NAP.

Collaborating with papermaking professionals at White Crow's rural facility in Fleetwood, Pa., each artist controlled all aspects of their book's production.

White Crow was established in 1980 by papermakers/printers Doug and Helene Zucco in order to provide quality pulp for their own expressive use as artists.

Book forms by the following artists are for sale:

Clytie Alexander, painter
Molissa Fenley, choreographer/dancer
AP Gorney, visual artist
Dan Hurlin, performance artist
John Jesurun, performance artist
Ralph Lemon, choreographer/dancer
Dan Welden, painter/printmaker
Michael Winkler, painter
John Yau, poet, with Max Gimblett, visual artist

Weiner untitled

A year before the Whitney Museum of American Art mounted his 40-year retrospective in 2008, **Lawrence Weiner** created this exquisite work to benefit New Arts Program. Measuring 15" x 12," it was offset printed in three colors by **Hawk Mountain Printing**, Leesport, Pa., in an edition of 40, signed. Still available for \$1,600 each.

Lawrence Weiner, untitled, 2007, offset on handmade cotton paper, edition of 40, signed, 15" x 12"

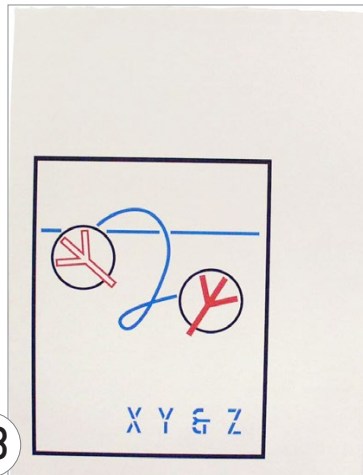

We reserve the right to limit quantities. All items also available for purchase at the NAP Gallery.

“Crating, Packing and Shipping Art” DVD—our top seller

The most thorough, professional, reliable documentation of its kind—a must for any artist or curator. **Crating, Packing and Shipping** details various crate types and includes an invaluable segment on “markings for shipping.” Produced by the New Arts Program and directed by David O’Connell of OCS Packing & Crating, the DVD is packed with trade secrets you can’t find anywhere else. Printed transcript included. 80-minutes. **DVD \$30. ITEM #1011**
vhs \$20. closeout item #1012

Kent Floeter monograph

BUILDING FLATNESS, THE ART OF KENT FLOETER—Painter Kent Floeter (1900- 2004) oversaw the creation of this monograph that, in both beauty and craft, is a benchmark of book publishing. Text contributions by Chuck Close and Raymond Ryan. Published in 2003 by Stephen David Editions Ltd, NY. 12.5”w x 11”h x 1.” 208 pages with 139 full-page color reproductions. [\$100 used on Amazon®.] **HARDCOVER (NEW) \$65. ITEM #1016**
+ \$10. S&H U.S. only

Robert Stanley signed poster

We love this 1985 edition, available signed and unsigned. This is a big one by an important twentieth-century American artist, striking in any office setting.

STANLEY 1985 POSTER (41”H X 26”)
SIGNED \$600. ITEM #1044

STANLEY 1985 POSTER (41”H X 26”)
UNSIGNED \$20. ITEM #1045

+ \$20. S&H U.S. only, one or more

Out of print

Our inventory of these NAP publications is dwindling—when they’re gone, they’re gone.

DANCE ON PAPER—Color catalog for 2001 exhibition held at Lehigh University. Visual works by over 50 choreographers. 53 pages.
SOFTCOVER \$9. ITEM #1035

IN AND OUT OF KUTZTOWN, 1974-1981—An image-filled documentary of the first seven years of the New Arts Program. Over two inches thick! A keeper. 426 pages.
SOFTCOVER \$30. ITEM #1033
+ \$10. S&H U.S. only

IN AND OUT OF NEW YORK—Catalog for 1980 NAP exhibit held at White Column in NYC with works by former Kutztown University students who lived and worked in NYC. 40 pages.
SOFTCOVER \$4. ITEM #1034

PRINTS OF NON-PRINTMAKERS—Catalog for 1988 exhibition held at Lehigh University—works by musicians, choreographers, and architects created through NAP Editions. 22 pages.
SOFTCOVER \$4. ITEM #1036

JULIUS TOBIAS: WORK FROM 1965 TO 1992—Exhibition catalog. 48 pages.
SOFTCOVER \$4. ITEM #1037

N.A.P.TEXT(S)—Literary journal loaded with stimulating writing, poetry, and visuals by literary, visual, and performing artists. #1-3 are exquisite 16-page booklets; #4-6 are in a stylin’ folded poster format. [#7 sold out]
PER ISSUE \$3. ITEM #1031

Keith Haring appearances 2-disc DVD set

KEITH HARING DVD—In 4 segments. Part 1: Kutztown native Haring in 1982 working on five drawings (30 min). Part 2: Haring animation originally shown in Times Square. (29 sec). Part 3: His 9/10/87 opening at NAP Space. Keith spent nearly five hours hanging with the crowd of 750 (10 min). Part 4: A 1982 public presentation by Haring (45 min). Printed transcript included. 86-minutes total.
DVD (2-DISC) SET \$33. ITEM #1013
VHS \$15. CLOSEOUT ITEM #1014

© K. Hamin

Haring posters sellout alert

In 1989 Keith Haring created a graphic for a concert poster screen printed the next year. A few of these first-run beauties remain—flea market priced... ditto the oversized 1984 “Kutztown Connection” benefit poster with Keith’s iconic heart graphic. Check them out on page 16 or in person at the NAP Gallery.

1990 HARING SILKSCREENED POSTER (22”H X 17”) \$30. ITEM #1042

1984 HARING OFFSET POSTER (33”H X 20”) \$30. ITEM #1043

+ \$20. S&H U.S. only; one or more



Glass, Gibson, Ashley, Reich, 6 others on CD compilation

CD CONNECTION is an exclusive NAP compilation of instrumental and vocal works by some of new music’s most influential composers. Each work was personally selected by its composer for this disc. Features the first ten musician/composers who had residencies at the New Arts Program: Philip Glass, Steve Reich, Jon Gibson, Meredith Monk, Robert Ashley, Malcolm Goldstein, Joan La Barbara, Connie Beckley, Peter Van Riper and Glenn Branca. One disc. 1996 release.
LIMITED-EDITION CD \$40. ITEM #1015

NAP gift certificates

For the artist or art lover in your life. Gift certificates can be applied to membership, artworks, NAP Thrift Shop items, and NAP Store items.
\$25. [no S&H fee] ITEM #1050



Always in style

Choose from two classic Keith Haring designs or Lawrence Weiner’s “Bridge” graphic silk-screened on back. All shirts, NAP logo on the front. Heavyweight 100% pre-shrunk cotton. Specify white or black for Keith Ts. Specify S, M, L, XL, XXL
BRIDGE (WHITE) \$20. ITEM #1021
KEITH HEART \$30. ITEM #1022
KEITH SCARECROW \$30. ITEM #1023

NAP store orders

ITEM #	ITEM NAME OR HELPFUL DESCRIPTION	SIZE/COLOR	QTY	COST PER ITEM	TOTAL
_____	_____	_____	_____	\$ _____	\$ _____
_____	_____	_____	_____	\$ _____	\$ _____
_____	_____	_____	_____	\$ _____	\$ _____
_____	_____	_____	_____	\$ _____	\$ _____
_____	_____	_____	_____	\$ _____	\$ _____
_____	_____	_____	_____	\$ _____	\$ _____
_____	_____	_____	_____	\$ _____	\$ _____
				MERCHANDISE TOTAL	\$ _____

SHIPPING AND HANDLING: Unless item is marked, apply the following fees:
1 item \$3. | 2-3 items \$4.50 | 4 or more items \$6. \$ _____
Shipping is U.S. only. Out-of-country ordering, please call 610-683-6440.
TOTAL AMOUNT DUE [add merchandise + shipping] \$ _____
Make check payable to: *New Arts Program*

NAME _____
ADDRESS _____
CITY/STATE/ZIP _____
PHONE [_____] _____ email _____



the nap store

FEATURED ITEM

Glass, Gibson, Ashley, Reich, 6 others on CD compilation

CD CONNECTION is an exclusive NAP compilation of instrumental and vocal works by some of new music's most influential composers. Each work was personally selected by its composer for this disc. Features the first ten musician/composers who had residencies at the New Arts Program. One disc. 1996 release.

LIMITED-EDITION CD \$40. ITEM #1015

Order form on previous page.

ABOUT THE PROJECT

CD CONNECTION is a work of art—actually ten works of art—representing some of America's most influential new music composers of the past century. Released in 1996, our limited-edition CD contains nearly 70 minutes worth of instrumental and vocal works, with first-time ever releases like Meredith Monk's rare gem, *Duet for Voice & Echoplex*, performed at Expo '67. The sound is beautifully mastered by Peter Van Riper and each performance was personally selected by its composer especially for this collection.

Affectionately referred to as "NAP The Early Years," *CD Connection* features ten musician/composers who were among the first 100 artists painters, sculptors, choreographers, composers and critics to have

participated in consultation residencies during New Arts' first seven seasons—1974 through 1982. Philip Glass and Steve Reich joined us during our very first season ... the rest is history.

If you've been paying attention, you may have noticed the cost of this collector's item has doubled since last year. Forgive us, but we only have a handful remaining with no plans for a reissue. This could be your last chance to grab a copy that's not bootlegged.

While **NAP Preview** acts as our annual calendar and a way to put the New Arts Program in your lap in a printed or on-screen form as a PDF, access to it for most of the public is only through our website—

newartsprogram.org. If your copy of the *Preview* came from the website, indulge us. But if you picked up a printed edition somewhere else, maybe you are unfamiliar with the site. We're here to change that.

Number one, our website is the easiest way to guarantee you have a copy of our latest *Preview* as soon as it is published, usually in June or July.

If you click on *Events and Schedules* in the menu, in addition to finding the latest *Preview*, you have access to downloads of all editions dating back to the 2013-2014 season—fun reads especially if you attended some of the events.

Newartsprogram.org is a great shortcut to **NAP On-Demand TV** programming. Two clicks and you can watch a recent show and have access to a library full of recorded artists' interviews.

If you haven't already seen a copy, don't miss **NAP Synopsis** which can be located under the *Artists and Synopsis* tab. Stroll down memory lane or explore NAP's amazing 49-year history. Residencies by over 450 artists, writers and performers are chronologically listed—1974 onward—along with other NAP highlights. Scroll to the very end of the page for a PDF download of your own copy of the complete *Synopsis* (use *Synopsis continued* link).

Wander around the site to discover a short teaser video about **Keith Haring's** connection to New Arts. (The full Haring video is for sale at the NAP Store (page 14 in this *Preview*.)

nap thrift shop

new and used artist materials and other finds for sale—shop Sep-July

NAP Space, Kutztown
During gallery hours
FRI/SAT/SUN 11–3:00
No mail orders
Prices good through 7/16/2023

Artists looking for good deals on artist materials and equipment can still strike gold at the NAP Thrift Shop. Stock is dwindling and we have ceased accepting materials donations. The list below represents most of our current inventory. Profits benefit New Arts Program.

Last chance—First run classic and late Haring concert posters

We're letting the last of our Keith Haring concert posters go at thrift shop prices, so we thought why not include them in our thrift shop. There are two posters—1990 “Benefit Concert” (the black silk-screened one at right) and 1984 “The Kutztown Connection” pictured below. Signed '84s sold out at \$600, but you can still get the identical first-run poster, minus the hand sig, for \$30. Haring's dated sigs are reproduced in the graphics of both posters anyway. You might try striking a deal buying both.

Best Artist super heavy-duty pine stretcher bars assorted sizes to 7' at 2014 prices.

Stretched cotton canvas, 5/8" profile, stapled on back (10 packs available each size; 2 to a pack) 18 x 24"—\$5.00 pack; 16 x 20"—\$4.00 pack; 12 x 16"—\$3.00 pack; 9 x 12"—\$2.00 pack

Cotton canvas, 9 oz: 72" wide—\$5.00/yd

Jerry's cotton duck, 15 oz double weave: 96" wide—\$13.00/yd

Utrecht cotton duck, 15 oz: 76" wide—\$9.00/yd

Utrecht cotton duck, 15 oz: 60" wide—\$7.00/yd

Pan pastels—over 50% off retail

New Radius toothbrushes (retail \$10)—\$5.00 ea

Golden Artist Colors “Just Paint” publications—free

1990 Keith Haring silkscreened poster “Benefit Concert” [22" h x 17"]—\$30.00

1984 Keith Haring offset poster “Kutztown Connection” [33" h x 20"]—\$30.00

BENEFIT CONCERT



**FRED FRITH
JON GIBSON
MALCOLM GOLDSTEIN
LENNY PICKETT
JOHN ZORN and a Special Guest**



at
ST. JOHN'S UCC
WHITEOAK AND WALNUT
STREET
KUTZTOWN, PA

THURSDAY, 26 APRIL 1990, 8 PM

Tickets are available for \$20 or a Program Membership at the door or at the
NEW ARTS PROGRAM 173 W Main Street, Kutztown PA, 215/683-6440.

← 22" x 17"

↓ 33" x 20"



THE KUTZTOWN CONNECTION

The Symphony Space
Broadway at 95th St.
New York, New York

Friday
September 28, 1984
8:00 pm

Saturday
September 29, 1984
2:00 pm

Saturday
September 29, 1984
8:00 pm

**Performances to
Benefit the
New Arts Program
of Kutztown,
Pennsylvania**
James F. L. Carroll,
Director

**Robert Ashley
Connie Beckley
David Gordon
Bill T. Jones
Richard Landry
Peter Van Ripper
David Shapiro
Arnie Zane**

**Johanna Boyce
John Cage
Constance
DeJong
Ellen Fisher
Jon Gibson
Alvin Lucier
Steven Paul
Miller
David Moss**

**Peter Gordon
Edgar Grana
Joan Jonas
Frank Lima
Meredith Monk
Lucio Pozzi
Steve Reich
Marta Renzi
and Dancers**

General Admission
Tickets:
\$10 each performance

Advance Purchase
Discount:
\$15 any 2 performances
\$20 all 3 performances

Tickets available,
after Sept. 1, 1984,
From: The Symphony
Space Box Office

Broadway at 95th St.
New York, NY 10025
(212) 864-5400



New Arts Program
support

The New Arts Program would not be in operation without the generous support of its members and sustaining sponsors.

sustaining sponsors



ESTATE OF JANET GOLOUB

Foundation for Contemporary Performance, NYC

Greenwich Collection Ltd.

Long, Barrell & Co. Ltd.

Certified Public Accountants
1150 Berkshire Blvd, Suite 240
Reading, Pa. 610-779-6000

Meet the Composer, NYC

Funding for Meet the Composer Inc. is provided with the support of the Pennsylvania Council on the Arts, ASCAP, the Virgil Thompson Foundation, and the National Endowment for the Arts

Phaedrus Foundation, NYC

St. John's United Church of Christ

N. Whiteoak and W. Walnut Sts.
Kutztown, Pa.

Sorrelli Jewelry

220 W. Main St, Kutztown, Pa.
610-894-9857

White Crow Paper Mill

Custom Papermakers
Fleetwood, Pa. 610-944-9061



This project was supported by the Pennsylvania Council on the Arts, a state agency, through its regional arts funding partnership, Pennsylvania Partners in the Arts (PPA). State government funding for the arts depends upon annual appropriation by the Commonwealth of Pennsylvania and support from the National Endowment for the Arts, a federal agency. PPA is administered in this region by the Berks Art Council.

business sponsors

Please patronize these local businesses who help fund NAP exhibitions and performances. Some offer discounts to our members.

Adam n' Eve Boutique

309 W. Main Street, Kutztown
Tu-F 10:00-6:00, Sa 10:00-5:00
610-683-8117

Audiology and Hearing Aid Service

114 S. Laurel Street, Kutztown
Virginia Grim 610-683-6108

Berkleigh Eye Care

Marlon G. Burt, O.D.
93 Constitution Blvd., Kutztown
610-683-3888

Betty's

bettyswraps.com
129 W. Main Street, Kutztown
610-621-2642
Wraps, smoothies, salads, soups

Cagefreedesign.com

Fine art, digital restoration,
photography
Emily Branch 610-413-9565

Campus Inn

Old Route 222, Kutztown
610-683-8721

Colorfin

PanPastel.com | SofftArt.com
Headquarters in Kutztown
484-646-9900
Makers of PanPastel™ ultra-soft
painting pastels and
Sofft™ Tools,
fine art and craft tools

East Penn Manufacturing

Lyon Station 19536-0147

First National Bank in Fleetwood

Main & Franklin Sts, Fleetwood
610-944-7676

Global Libations

546 Noble St., Kutztown
484-646-9683
Roasting the finest fair-trade/
organic coffee daily
10% off order with NAP mem. card

Cheryl A. Haughney Realtor®, ABR, SRS

LV and Berks residential specialist
for Berkshire Hathaway/
Fox & Roach, Realtors® ABR, SRS
484-225-9437

Main Street Inn

Boutique Hotel
401 W. Main Street, Kutztown
610-683-0401

Mark's Sandwich Shop

123 W. Main Street, Kutztown
7 days a week / 10:00-10:00
610-683-3626
A Kutztown tradition since 1966

Mr. Food Convenience Store

342 W. Main Street, Kutztown
7 days a week / 6:30 am-11:00 pm
610-683-7315

Pretty Dirty Ladies

prettydirtyladies.com
Toll-free 1-877-944-2211
Garden design and maintenance

Radius

radiustoothbrush.com
1-800 626-6223

SOS Business Machines

28 S. Center Avenue, Leesport
M-F 9:30-5:00
610-926-1299
Canon copier/fax sales,
service, supplies

Silver Maple Veterinary Clinic

silvermaplevet.com
Route 222, Kutztown
610-683-7988
Dogs, cats, ferrets, horses

Uptown Espresso Bar

466 W. Main Street, Kutztown
M-F 7:00 am-9:00 pm
Sa 8:00 am-7:00 pm
610-683-6401
10% off order with NAP mem. card

If you are a local business that wants to be recognized as an NAP supporter, call us to be included here.

—610-683-6440—



PHOTO: ANNIE LIEBOVITZ

“New Arts is
a nonacademic
approach to
a nonacademic
subject,
and it works!”

—PHILIP GLASS